

<3F>

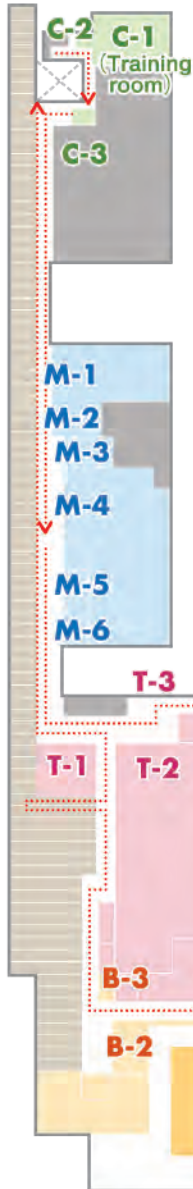

C Administrative Building

- C-1 Introductory video
- C-2 Model of the plant and facilities
- C-3 Timeline of waste management in Machida (Historical timeline)

M Incombustible/Bulky Waste Treatment Facility

- M-1 Machine/Manual sorting line
- M-2 Sort master (Exhibition of actual objects)
- M-3 Incombustible/Bulky waste central control room
- M-4 Incombustible/Bulky waste pit
- M-5 Platform
- M-6 See how the Air Curtain works!

T Heat Recovery Facility

- | | |
|--------------------------------|-----------------------------------|
| T-1 Platform | T-6 The secret of the large stack |
| T-2 Waste pit | T-7 Steam turbine generator |
| T-3 Feel how big the crane is! | T-8 Air cooled condenser |
| T-4 Ash pit | T-9 Central control room |
| T-5 FIRE ROAD | T-10 The 3Rs tap challenge |

B Biogasification Facility

- B-1 Fermentation tank
- B-2 Sugo Lab (Biogas generator)
- B-3 Generating power by bicycle/generating power from vibrations



▲ Introductory video

Get an overview of the Machida City Bio-Energy Center by video. Unique little characters will guide you through the facilities.

M Incombustible/Bulky Waste Treatment Facility



◀ Sort master (Exhibition of actual objects)

Watch an interview with an employee who will introduce hand-sorting, and take a garbage sorting quiz. Learn all about sorting!



◀ See how the Air Curtain works!

An "air curtain" protects odors from escaping to the outside from the entrance/exit to the dumping platform. Feel how an air curtain works!

T Heat Recovery Facility



◀ Feel how big the crane is!

A trick art photo spot that allows you to feel the immense size of the waste crane up close.



◀ Ash pit

You can see the ash pit where the incinerated ash is stored. Also, watch a video on how eco-cement is made.



Administrative Building

A place for promoting communication

The starting point for plant tours and a zone for contemplating the environment and the future that fosters communication among local residents.

◀ Model of the plant and facilities



Gives an overview of the Machida City Bio-Energy Center. Easily learn about the process flows at each facility.



▶ Timeline of waste management in Machida (Historical timeline)

Learn the history of how the city and its citizens have managed garbage over the years.

START ↓

Communication

Material

Thermal

FIRE ROAD ▶

Watch a powerful video on the incineration process inside the incinerator. The interactive experience allows you to increase the combustion by waving your arms up and down.



▼ The secret of the large stack

You can observe the stack from a monitor. Also, there is a large circle on the floor that matches a cross-section of the stack to give you a feel for its actual size.



▼ Maintaining the safety of waste treatment (Central control room)

With technicians' words shown in speech bubbles, it is easy to understand what takes place in the central control room.



The 3Rs tap challenge ▶

A game for preventing the town from filling up with garbage. Tap on the correct 3R actions and learn about the 3Rs.

▼ Feel the blowing of the steam condenser's huge fan! (Air cooled condenser)

Feel the blowing of the steam condenser's huge fan, which cools the steam.



B Biogasification Facility

A facility for recovering biogas—extracting energy from organic waste

In this zone you can learn how biogas power generation works and how it is used.



▲ Sugo Lab (Biogas generator)

Learn all of the amazing things about biogasification in an arch-shaped space that simulates being in the fermentation tank. You can take pictures with methanogens.



◀ Become a Machida waste professor!

Place garbage or resource objects on the screen to see information on recycling or take a quiz or poll on waste. Through such content you can deepen your understanding.



Generating power by bicycle/ Generating power from vibrations ▶

Try generating power by bicycle or from vibrations. Also, learn how much power is generated at the Machida City Bio-Energy Center in real time.

